

I, Lynne R. Erb, Clerk-Treasurer of the Village of New Glarus, Wisconsin, hereby certify that this is a true and correct copy of the Official Map adopted by the Village Board of the Village of New Glarus, Green County, Wisconsin, by Resolution 08-23 dated 9/16/08.

Dated this 16th day of September, 2008

Lynne R. Erb, Clerk-Treasurer

Seal

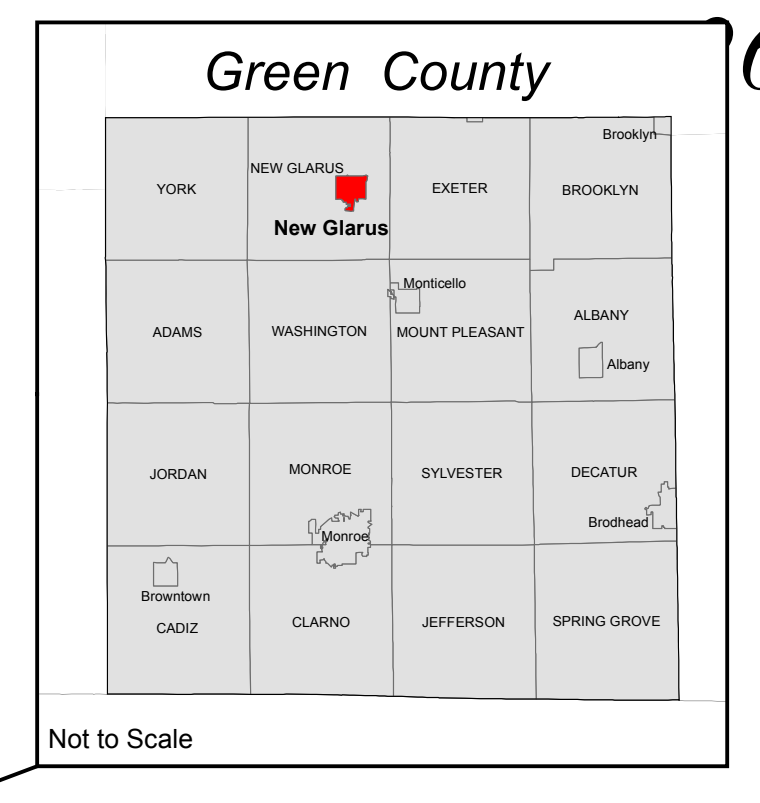
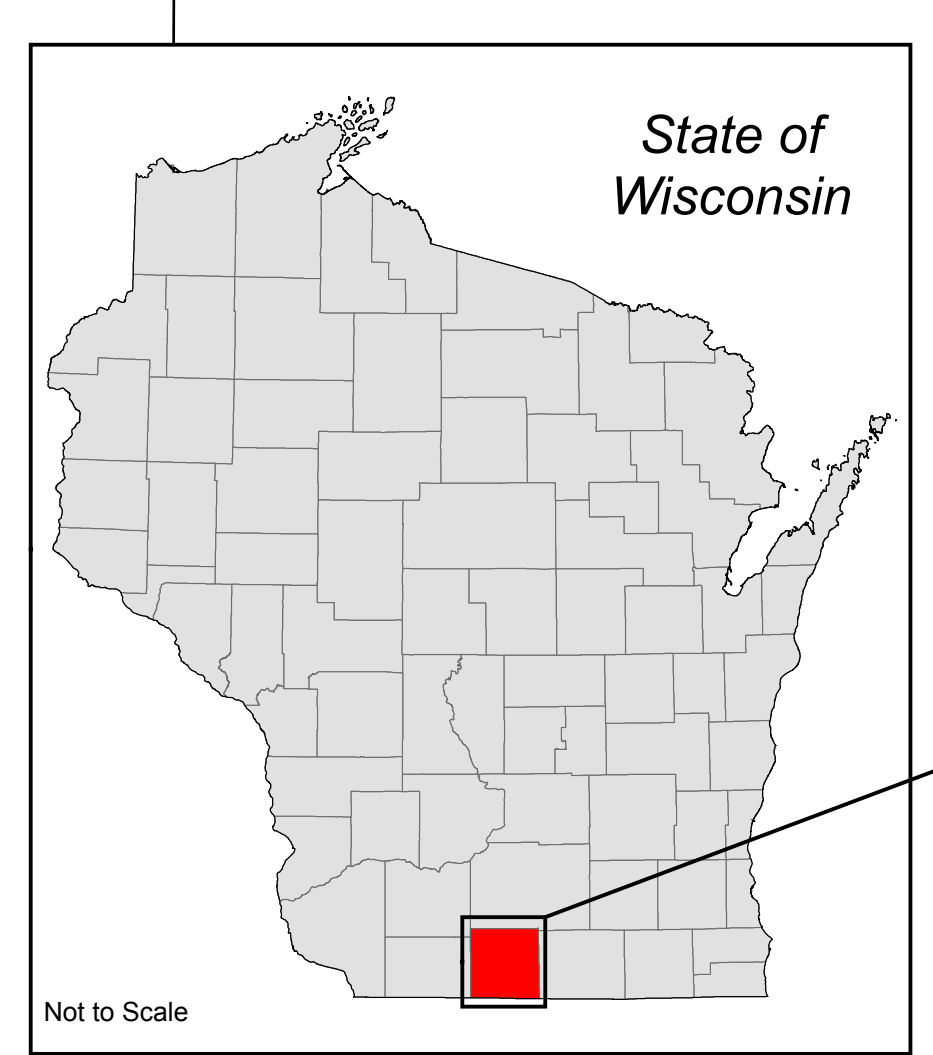
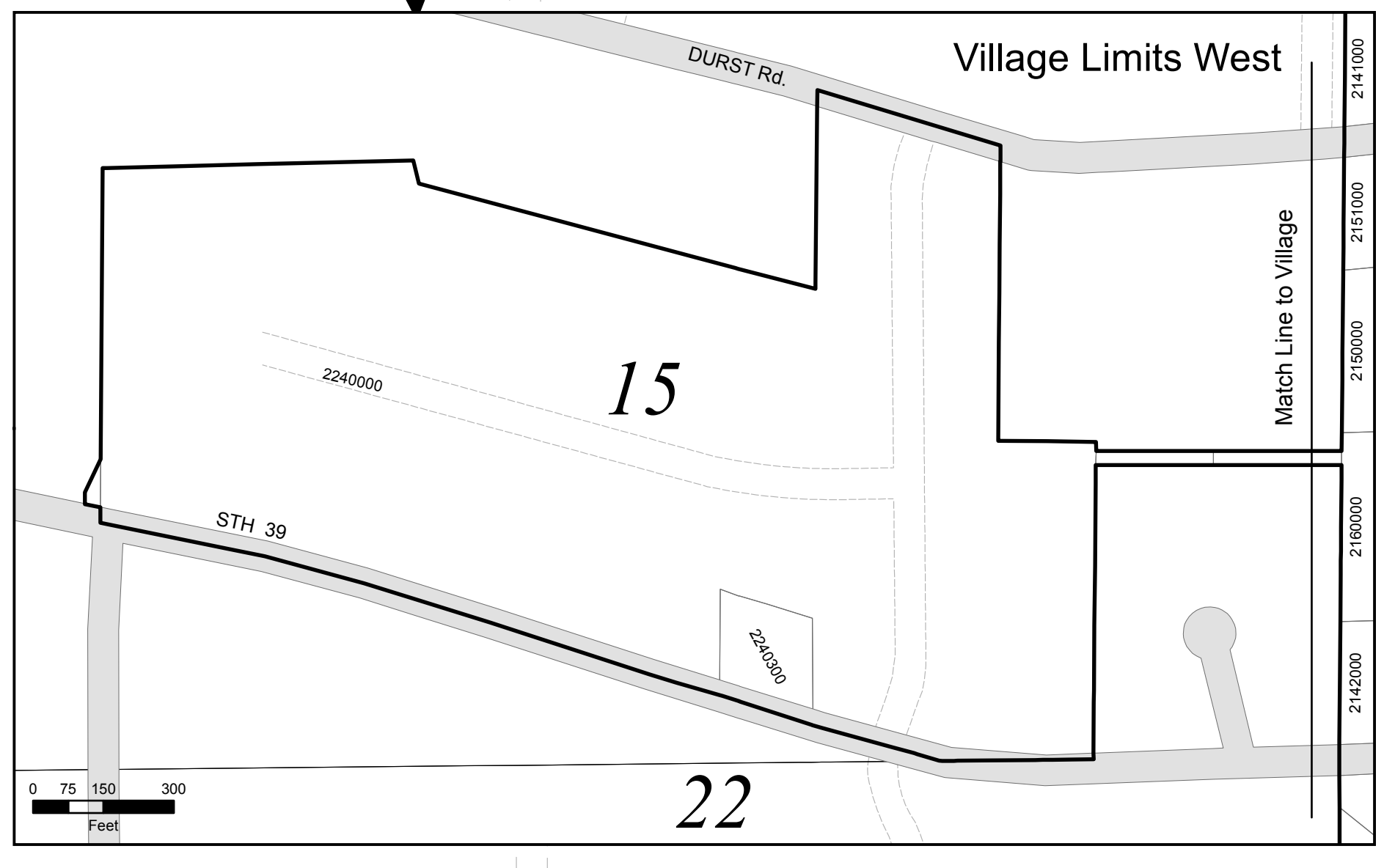
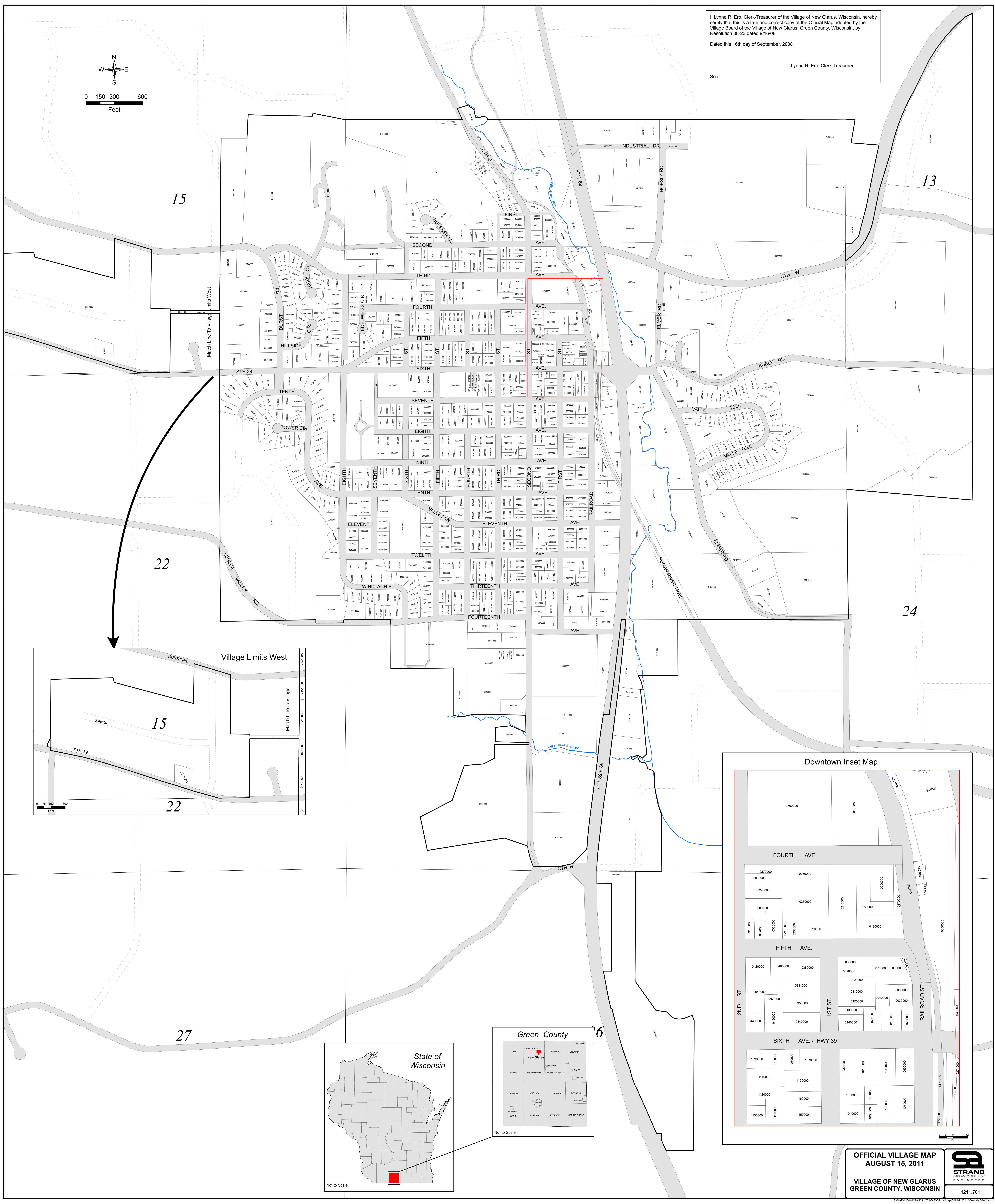
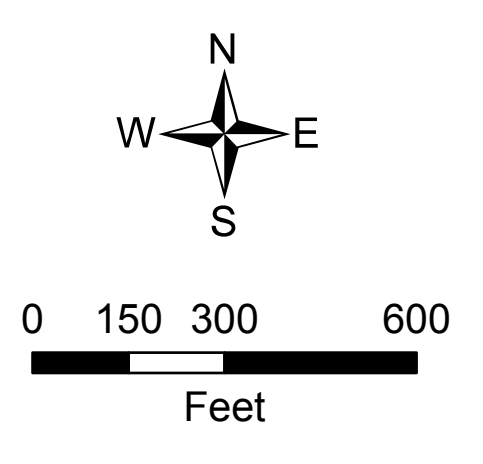

OFFICIAL VILLAGE MAP
AUGUST 15, 2011
VILLAGE OF NEW GLARUS
GREEN COUNTY, WISCONSIN



1211.701